



55 Armthorpe Road

Doncaster, DN2 5LU

Asking Price £100,000

Two bedroom ground floor flat in a purpose built building, directly opposite the Doncaster Royal Infirmary Hospital. Offered with no onward chain, the property comprises of; two double bedrooms, lounge, fitted kitchen, bathroom, shared front and side gardens. The property also benefits from off road parking and an outdoor storage cupboard.

Wheatley Hills has a range of local amenities and has excellent access to the motorway networks and transport links. A viewing is strongly recommended as this is the perfect opportunity for a first time buyer or an investor.

- Two bedroom ground floor flat
- No onward chain
- Directly opposite Doncaster Royal Infirmary
- Leasehold
- Off road parking
- Situated in a popular location close to a range of local amenities and excellent transport links

Viewing

Please contact our Office on 01302 751616 if you wish to arrange a viewing appointment for this property or require further information.

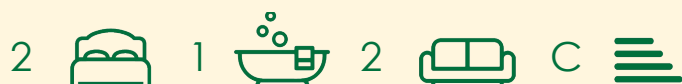

Floor Plan

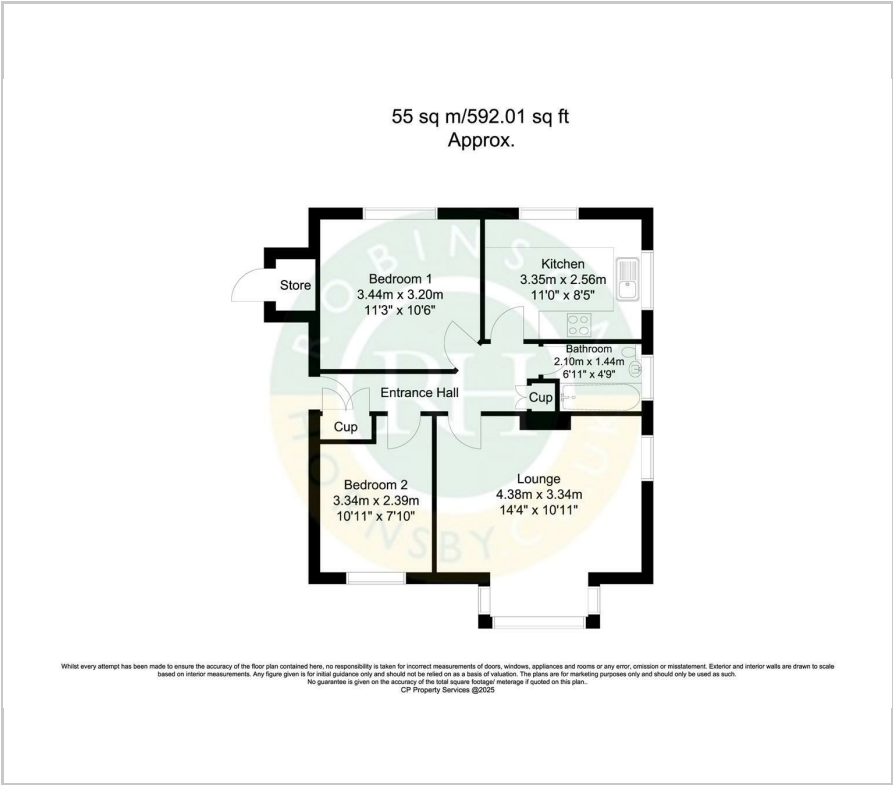

Area Map



Energy Efficiency Graph

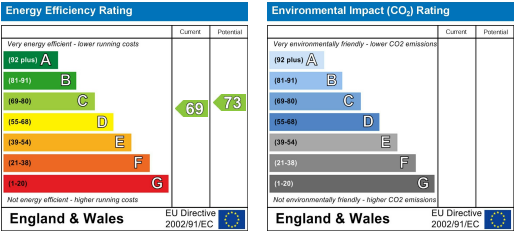

These particulars, whilst believed to be accurate are set out as a general outline only for guidance and do not constitute any part of an offer or contract. Intending purchasers should not rely on them as statements of representation of fact, but must satisfy themselves by inspection or otherwise as to their accuracy. No person in this firms employment has the authority to make or give any representation or warranty in respect of the property.